

# SWIVEL CLEATS & BASES

## A-C. SWIVEL 360 CLEATS

Swivel cam cleats are ideal for main traveler control and up-release jib cleating systems. Use a "heavy duty" swivel for spinnaker sheet control or H-20 main traveler control. Cam cleats and fairleads should be selected on the basis of need. Order plastic base pads and fasteners separately. Small Ronstan swivel features small C-cleat with fast track fairlead and bull's-eye fairlead. Line size: 1/8"-5/16".



A. 25-3020 Heavy Duty Swivel, Aluminum Cam-Matic® Cleat, Roller Fairlead \$70.00

25-3014 Swivel, Aluminum Cam-Matic® Cleat, Bull's-eye \$61.00

B. 25-3010 Swivel, Carbo-Cam™ Cleat, Bull's-eye \$51.00

25-3012 Heavy Duty Swivel, No Cleat, No Bull's-eye \$22.00

C. 21-0067 Ronstan Small Swivel 360 \$45.80

21-0058 Ronstan Large Swivel 360 \$52.90

## PLASTIC BASE PADS

Use a base pad to mount a cleat on a surface which is not flat, such as a crossbar. Swivels mount on 3-hole plastic base pads. Select bases that are appropriate for the installation. Use flat base pad (#25-3001) to mount swivel cam to flat decks, elliptical pad (#01-0109) for Hobie® (except for H-20) or Prindle crossbars, or round pad (#01-8014) for Nacra and H-20 crossbars.



## D. OFFSET BASE PAD KIT

Offset base fits Hobie® and Prindle elliptical crossbars. Includes base and fasteners.

07-1162 Complete Kit \$8.40

Replacement Fasteners:

19-1620 Self-Tapping Screw (order 2) \$.34

19-1516 Machine Screw (order 1) \$.25

19-2016 Nut (order 1) \$.16



## E-F. CONTOURED BASES 2" ROUND

Polyurethane bases provide flat mounting surfaces for mast rotation control cleats, barberhauler cleats, or H-16 jib trim cleats. Use to mount Harken Micro Cleat (#28-0279), small Ronstan C-Cleat (#21-5000), or Ronstan Small or Large Swivel 360 Cleats (#21-0067 or #21-0058). Each base can be port or starboard, depending on how cleats are installed. #10 FHSMS is an appropriate length. Bases are 2" in diameter.

E. 01-8014 Fits H-20 or Nacra Round Crossbar \$4.00

F. 01-0109 Fits Hobie® or Prindle Elliptical Crossbar \$5.50

## G-H. BASE KITS FOR SWIVEL 360 CLEATS

For Harken®, Hobie® or Murray 360 cleats without swivel base adapters.

Kits include one 3-hole base, one swivel base adapter (#25-3001), plus three #10 FHSMS (#19-1626). Ronstan swivel 360 cleats include swivel base adapters, so this kit is not necessary.

G. 01-0110 Kit fits Hobie® or Prindle Elliptical Crossbar \$9.50

01-8013 Kit fits H-20 or Nacra Round Crossbar \$8.00

H. 25-3001 Swivel Bar Adapter \$3.00  
19-1626 Replacement Screw: #10 x 1.5" FHSMS \$.36

## CONTOURED BASES 4-HOLE

For barberhauler or mast rotation control cleats with bull's-eyes or roller fairleads. The polyurethane bases are designed to be used with Harken Cam-Matic cleats (#28-0150 or #28-0365) or Ronstan medium C-Cleats (#21-5010) plus a bull's-eye or roller fairlead. For Nacra or H-20.

01-8011 Flat Top Port \$8.00

01-8012 Flat Top Starboard \$8.00

# FAIRLEADS & SHEAVES



## ROLLER FAIRLEAD

Retrofit bull's-eye fairleads with low friction roller fairleads!

Fasteners included.

25-3002 Complete Kit \$12.95

00-3002-4 Replacement Plastic Roller \$2.25

00-3002-3 Replacement Stainless Bushing \$1.20

19-2915 Replacement Screw—each \$.36

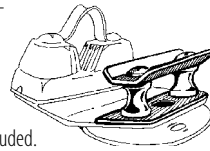

## J-K. BULL'S-EYE FAIRLEADS

Stainless ferrule eliminates grooving. Line capacity: 7/16". Mounts with two screws.

J. 25-0323 Bull's-eye with Ferrule \$6.00

K. 22-7851 Bull's-eye Fairlead \$2.25

19-2915 Screw #10-32x1" \$.36



## FAIRLEAD STRAPS

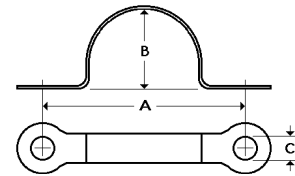

Item #	Description	A	B	C	Price
25-0338	Mini	1" (25mm)	1/4" (6mm)	3/16" (5mm)	\$1.25
28-0281	Micro	1-1/16" (27mm)	3/8" (10mm)	5/32" (4mm)	\$1.20
23-0921	Small	1-1/4" (31.4mm)	1/2" (12.7mm)	3/16" (5mm)	\$1.60
25-1065	Seaway	1-7/16" (36.5mm)	5/8" (16mm)	3/16" (5mm)	\$2.00
28-0137	Harken®	1-1/2" (38.1mm)	3/4" (19mm)	1/4" (6mm)	\$2.00
21-0499*	Ronstan	1-1/16" (27mm)	5/16" (8mm)	5/32" (4mm)	\$3.65

\*Eyestraps with Ferrule Eye

## REPLACEMENT SHEAVES

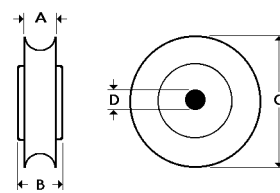

Item # / Description	A	B	C	D	Price
21-0251 Mast Head N-5.5/5.8/6.0, Prindle 16, Sol-18 1/4" (6mm) 3/8" (10mm) 1-7/16" (39mm)				1/4" (6mm)	\$3.50
28-0160 Replacement Harken® Ball Bearing H-17/20 5/16" (8mm) 17/32" (14mm) 1-3/16" (30mm)				1/4" (6mm)	\$7.80
50-60620000 Mast Head/Base H-18 3/8" (10mm) 3/8" (10mm) 1" (25mm)				1/4" (6mm)	\$6.00
21-1741 Prindle Rudder (upper upgrade) 3/16" (5mm) 1/4" (6mm) 3/4" (19mm)				1/4" (6mm)	\$2.50
56-4009 Prindle Rudder (upper) 1/4" (6mm) 1/4" (6mm) 1/2" (13mm)				1/4" (6mm)	\$.30
56-6503 Mast Head N-5.0/5.2/5.7 3/8" (10mm) 1/2" (13mm) 1-3/4" (44mm)				9/32" (7mm)	\$4.00
56-6803 Mast Head P-18/18.2/19 11/32" (9mm) 1/2" (13mm) 1-1/16" (27mm)				1/4" (6mm)	\$3.50
56-6804 Mast Base P-18/18.2/19, Nacra 2003 & Later Mast Head 5/16" (8mm) 13/32" (11mm) 1-1/8" (28mm)				1/4" (6mm)	\$3.50
28-0415 Ball Bearing Sheave for 16mm Air Block 3/16" (5mm) 5/16" (8mm) 5/8" (16mm)				3/16" (5mm)	\$7.10
50-20614210 Comp-Tip Mast Head Sheave 9/16" 5/8" (16mm) 2-1/4" (57mm)				3/8" (10mm)	\$5.95